

SHIMANO XTR Rear Disc Brake

BR-M965 Brake Caliper
SM-BH96 Brake Hose

SM-RT96 Disc Rotor (φ160 mm)

SM-RT62M Disc Rotor (φ180 mm)

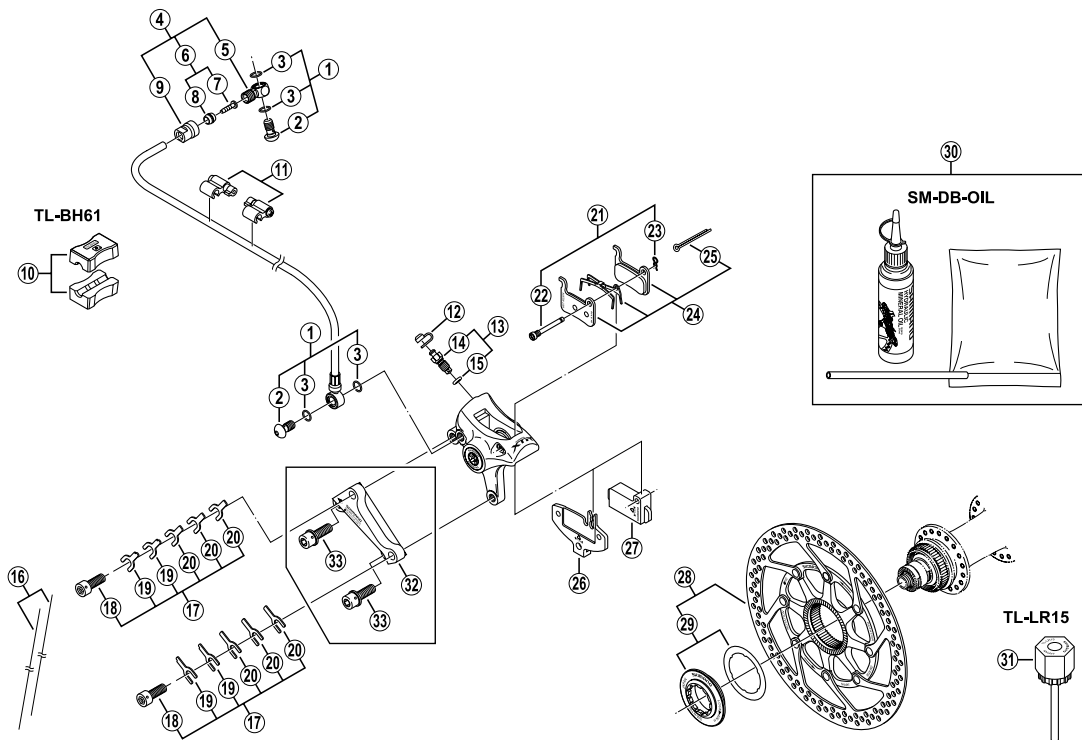

| ITEM NO. | SHIMANO CODE NO. | DESCRIPTION |
|----------|------------------|--|
| 1 | Y-8H0 98010 | Banjo Bolt & O-Ring |
| 2 | Y-8H0 01500 | Banjo Bolt |
| 3 | Y-8SY 28000 | O-Ring |
| 4 | Y-8CL 98110 | Banjo Unit |
| 5 | Y-8H3 02000 | Banjo A |
| 6 | Y-8H2 98020 | Olive & Connecting Insert |
| 7 | Y-8H2 02000 | Connecting Insert |
| 8 | Y-8H2 04000 | Olive |
| 9 | Y-8H3 03000 | Banjo Nut |
| 10 | Y-8H1 98030 | TL-BH61 Special Tool (2 pcs.) |
| 11 | Y-830 98040 | SM-HANG Hose Supporter A & B |
| 12 | Y-8B2 14000 | Bleed Nipple Cap |
| 13 | Y-8CL 98050 | Bleed Nipple & Seal Ring |
| 14 | Y-8CL 24000 | Bleed Nipple |
| 15 | Y-8B5 11001 | O-Ring for Bleed Nipple |
| 16 | Y-8B2 98010 | Wire (2 pcs.) |
| * 17 | Y-8CL 98060 | Caliper Fixing Bolt Unit |
| 18 | Y-8B2 32200 | Caliper Fixing Bolt (M6 x 15) |
| 19 | Y-8CL 13000 | Spacer (0.5 mm) |
| 20 | Y-8CL 14000 | Adjusting Washer (0.2 mm) |
| 21 | Y-8CL 98070 | Pad Axle & Snap Ring |
| 22 | Y-8CL 11000 | Pad Axle |
| 23 | Y-8B2 12000 | Snap Ring |
| 24 | Y-8CL 98010 | Metal Pad (M06) & Spring w/Split Pin |
| | Y-8CL 98020 | Resin Pad (M07) & Spring w/Split Pin |
| 25 | Y-8DB06000 | Split Pin |
| 26 | Y-8CL 12000 | Pad Spacer |
| 27 | Y-8CL 18000 | Spacer for Bleeding |
| 28 | Y-8CL 98080 | SM-RT96 Disc Rotor Unit (φ160 mm) |
| | Y-8HS98060 | SM-RT62M Disc Rotor Unit (φ180 mm) |
| 29 | Y-8CL 98090 | Lock Ring & Washer for SM-RT96 |
| | Y-8HS98030 | Lock Ring & Washer for SM-RT62M |
| 30 | Y-839 98010 | Mineral Oil Bleed Kit (50 ml) |
| 31 | Y-120 09230 | TL-LR15 Lock Ring Removal Tool |
| 32 | Y-817 75000 | A-Standard Mount Adapter (SM-MA-R180S/S) for Disc Rotor φ 180 mm |
| 33 | Y-8B5 12000 | Adapter Fixing Bolt (M6 x 19) |

0507-2149E

Specifications are subject to change without notice.

SHIMANO